

Door

Index (Coupe Front Door)

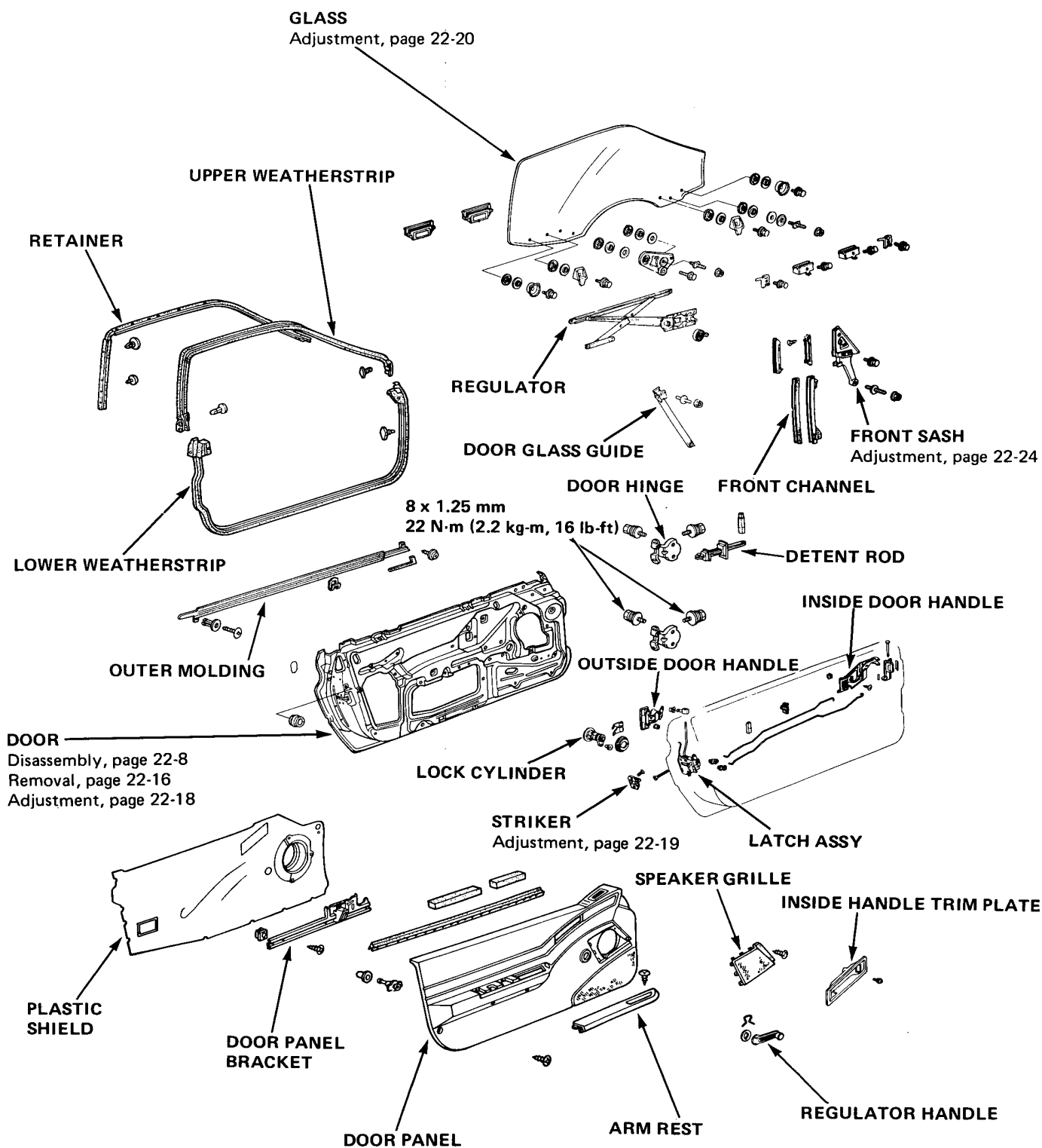



(2D H/B Front Door)

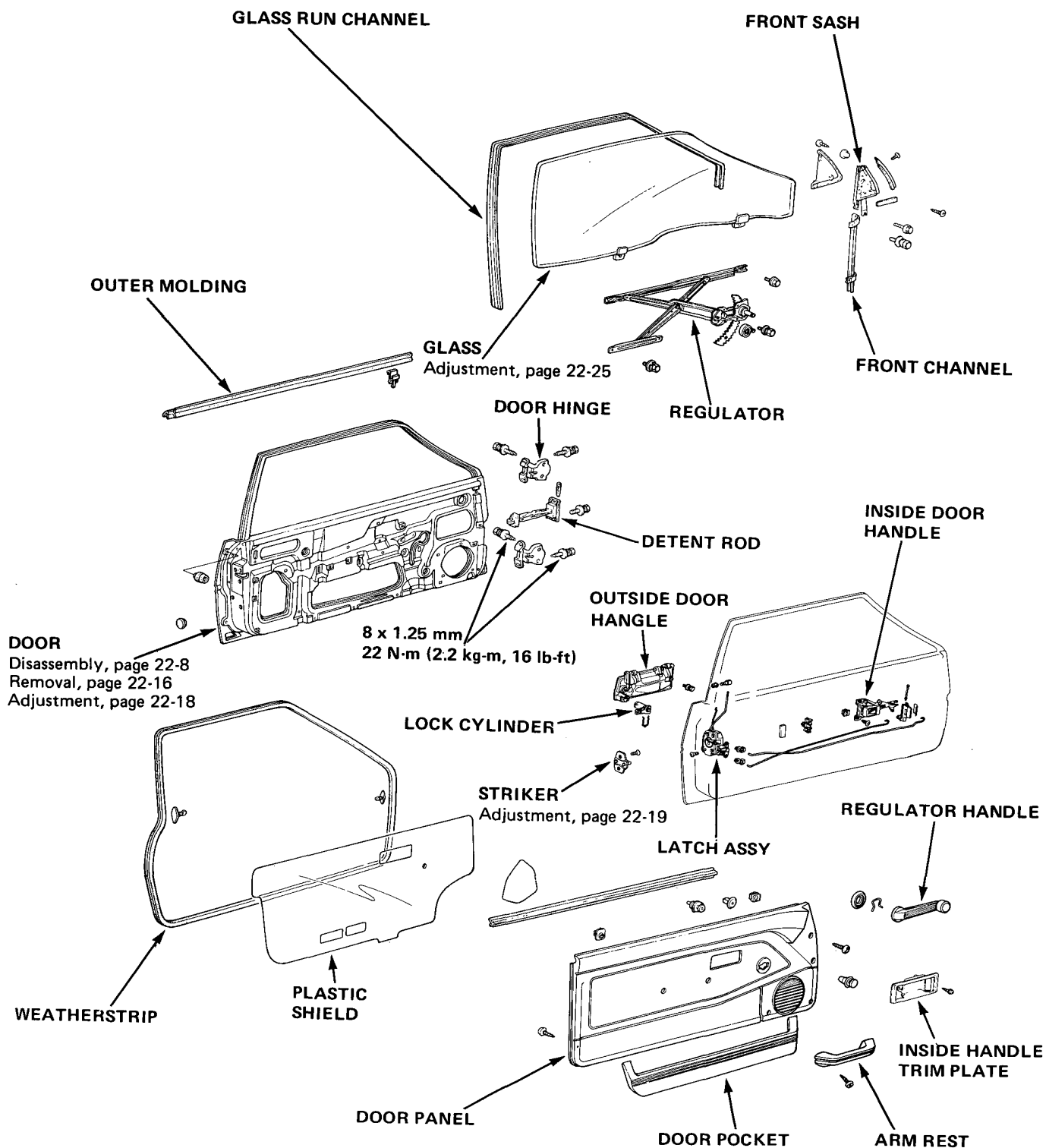

Door

Index (4D Front Door)

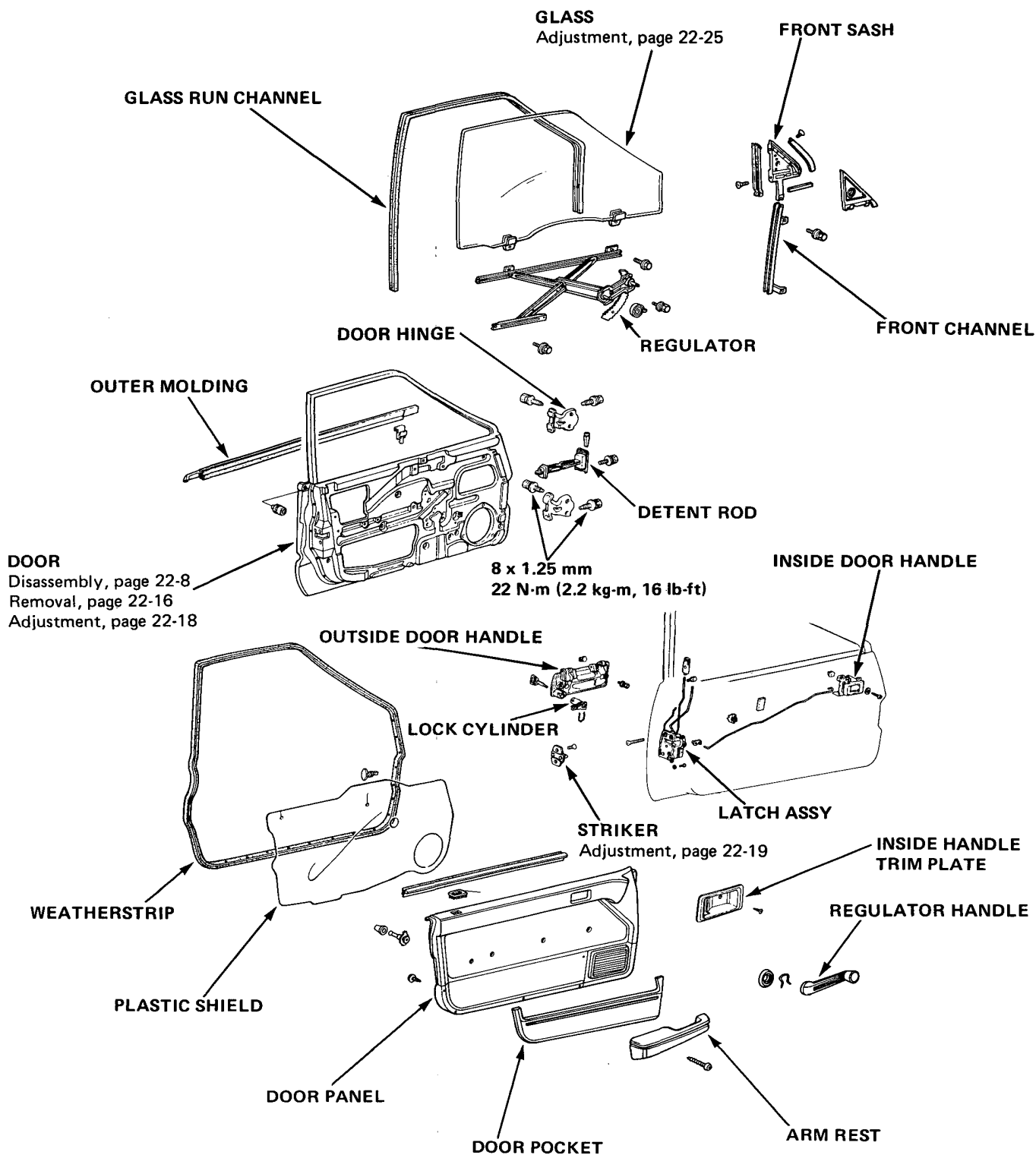



(4D Rear Door)

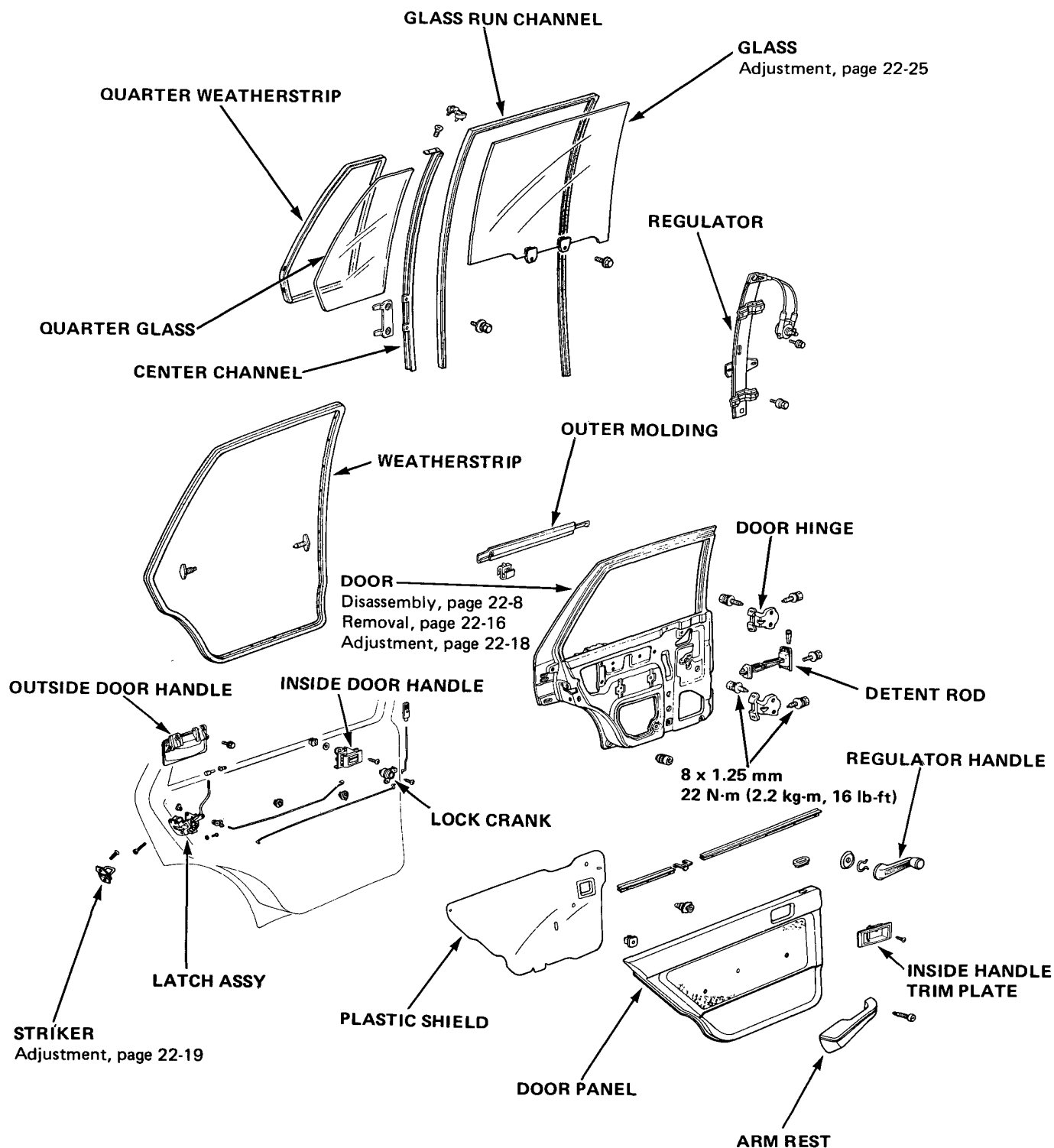

Door

Index (4D H/B Front Door)

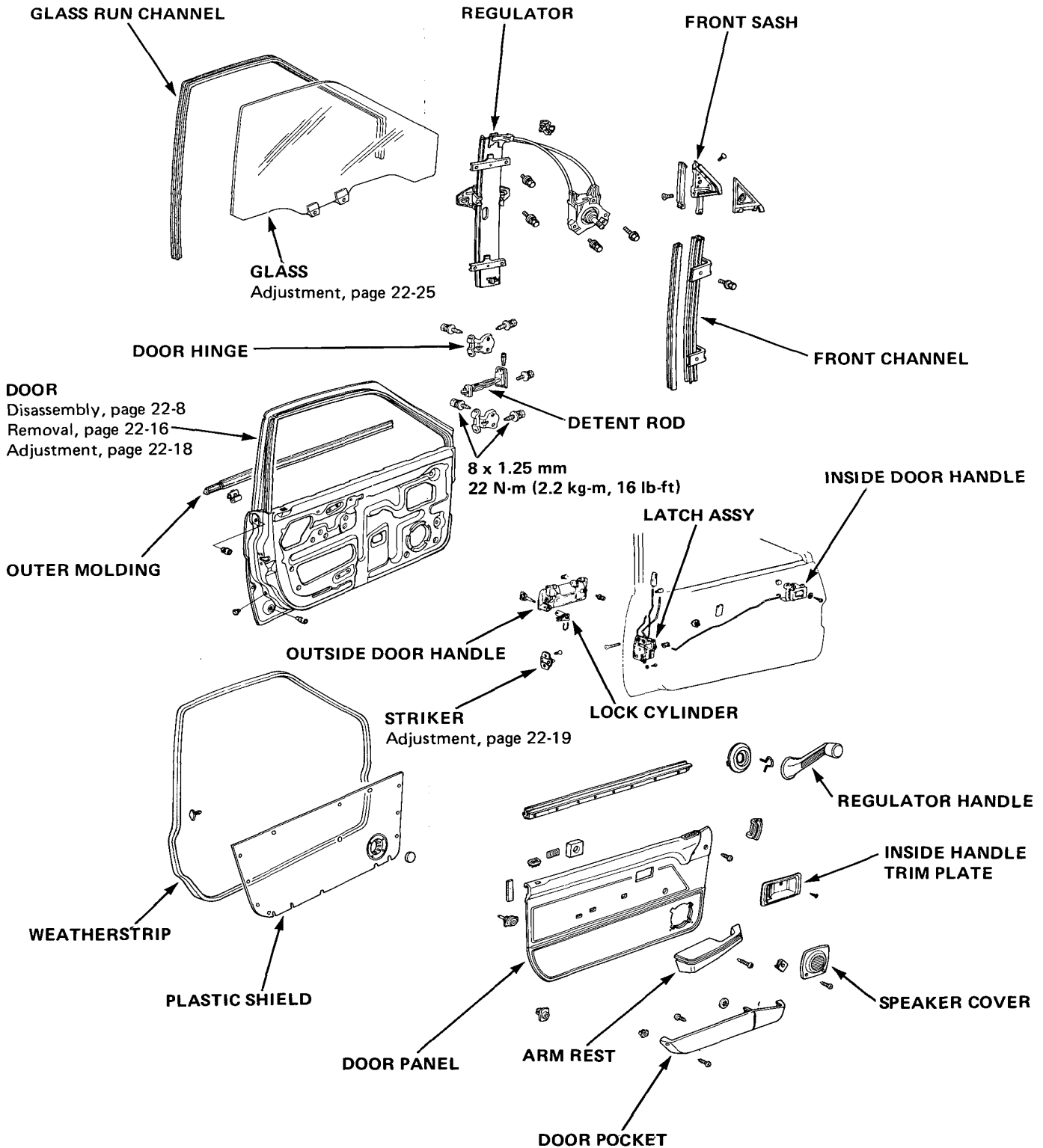



(4D H/B Rear Door)

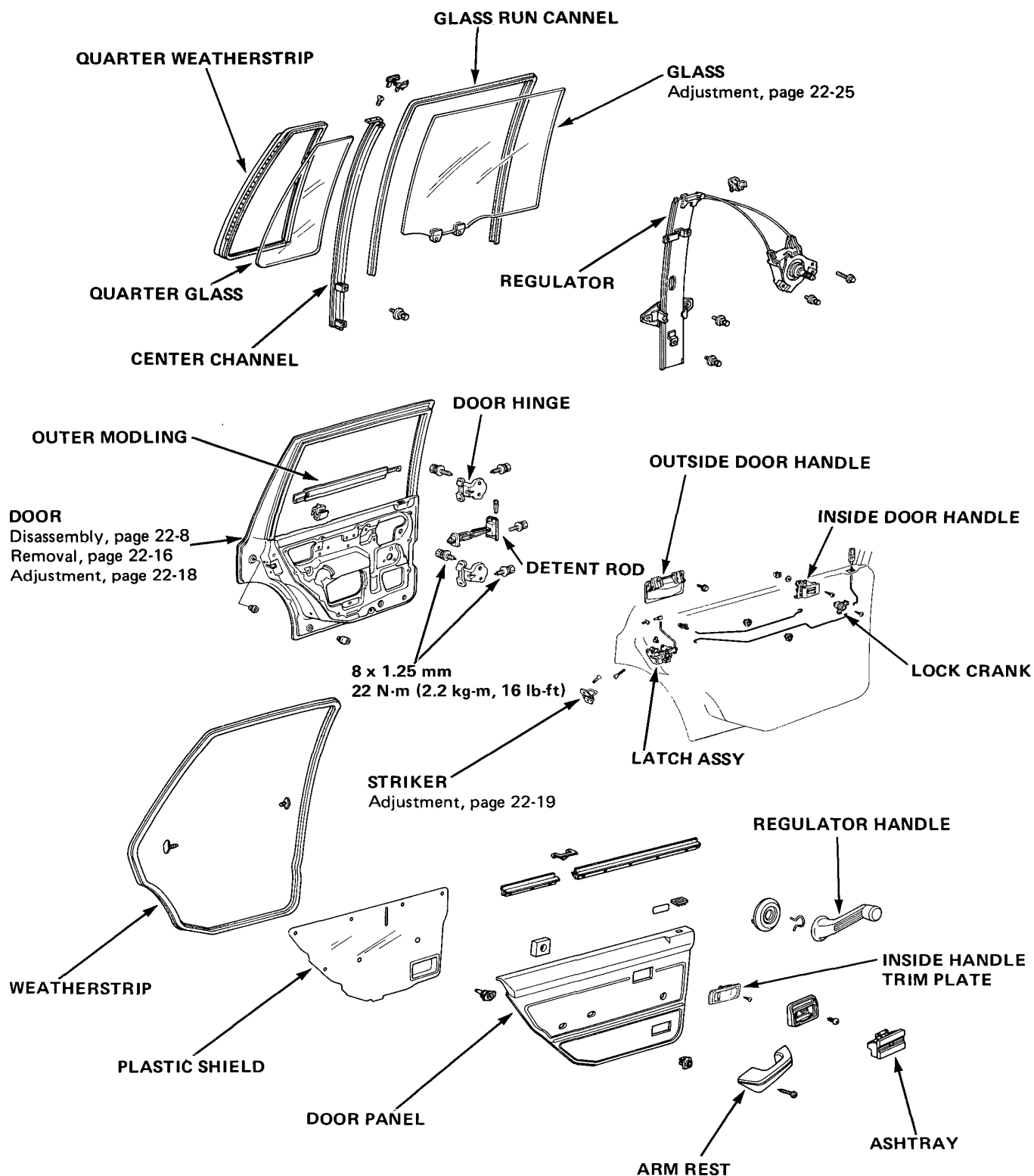

Door

Disassembly

1. Push the clip off the regulator handle with a screwdriver, or pull it off from the other direction with a wire hook. Remove the regulator handle.

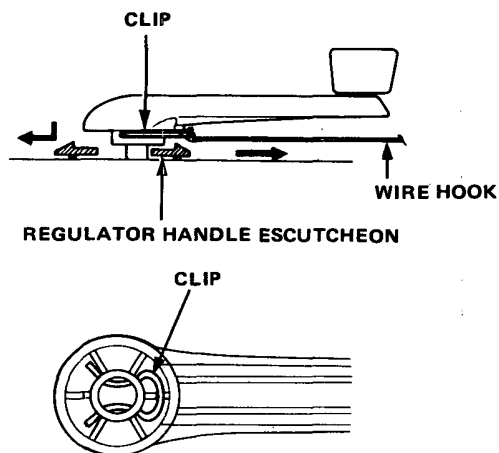

2. Remove the screw attaching the trim plate, then remove the trim plate carefully to avoid damaging it or its hook.

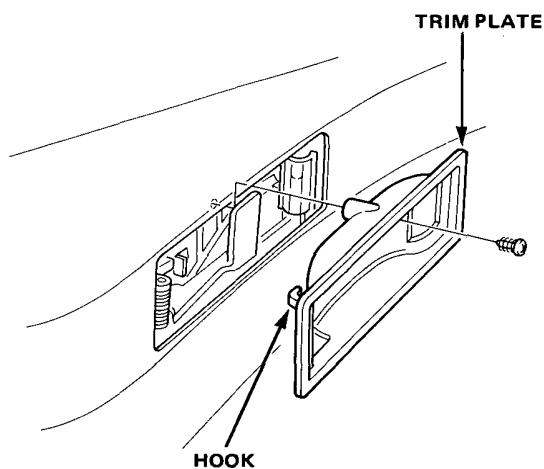

3. Remove the screws, then remove the arm rest.

CAUTION: On Coupes, also remove the speaker but be careful that you don't damage the retaining tabs on the speaker grille or armrest.

Coupe:

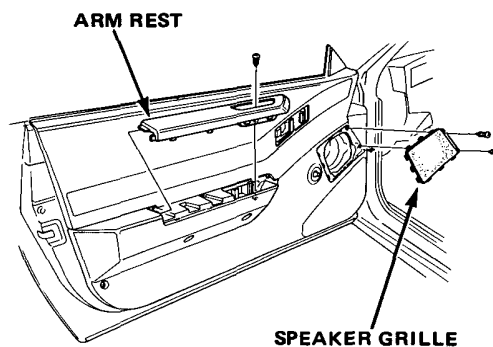

2D H/B, 4D, and 4D H/B:

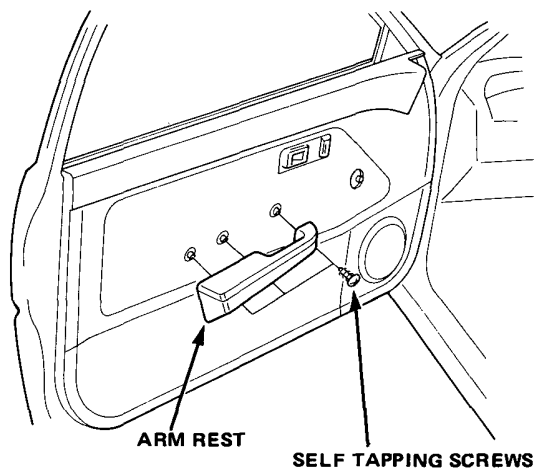



4. Remove the rear view mirror.

- Remove the screw and control knob.
- Carefully pry off the cover panel with a screwdriver to avoid damaging it, then while holding the mirror with one hand remove its 3 screws with the other.
- Remove the mirror from the door.

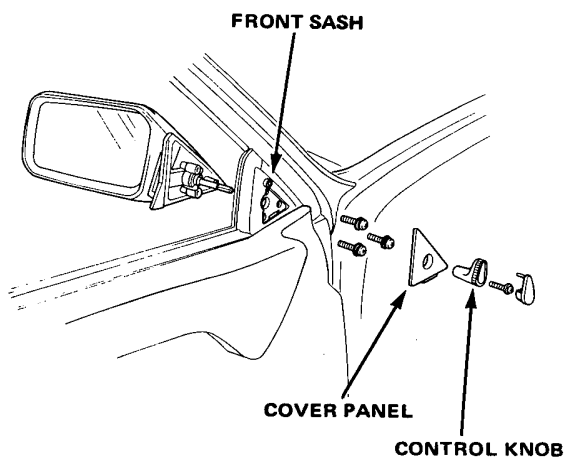

5. To remove the door panel, first remove all retaining screws (see drawings), then insert a stiff putty knife between the panel and the plastic shield, slide it around the edge until it hits a retainer clip, then pry it up sharply to remove the clip. Repeat at all clip locations until the panel is free, then lift it straight up off the window sill.

NOTE: Remove the panel with as little bending as possible to avoid creasing or breaking it.

○ : Screw Locations

△ : Clip Locations

Coupe Front Door

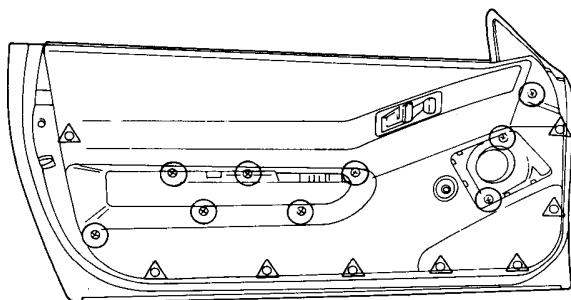

2D H/B Front Door

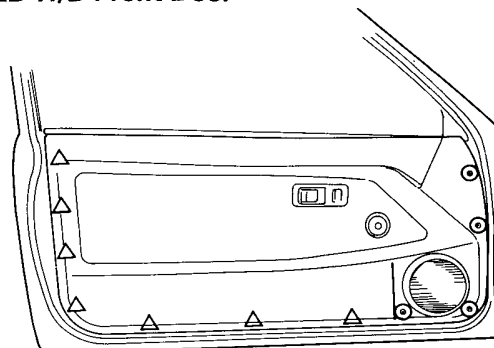

4D Front Door

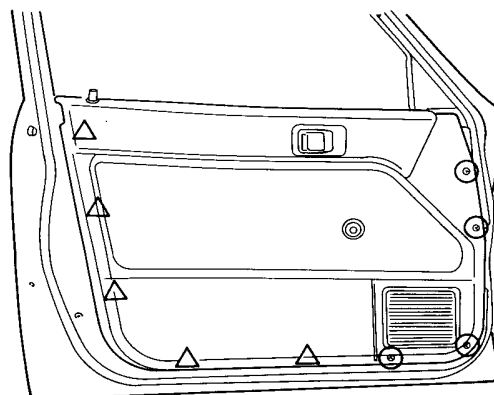

4D Rear Door

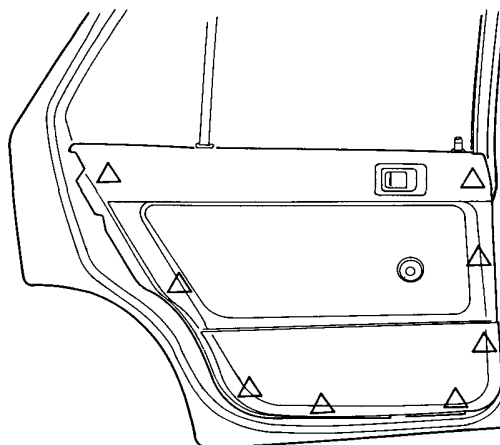

(cont'd)

Door

Disassembly (cont'd)

4D H/B Front Door

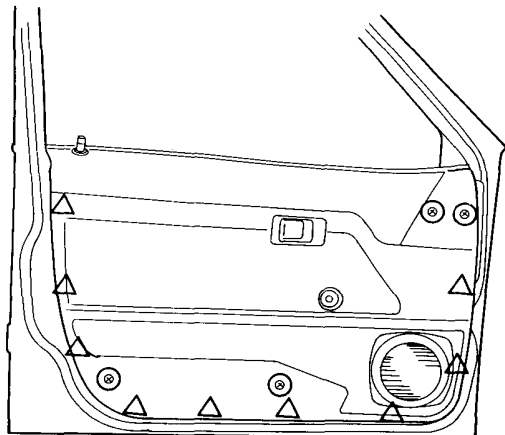

4D H/B Rear Door

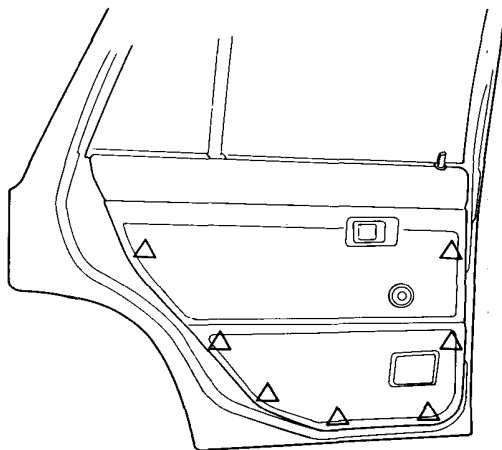

6. Remove the screws, then remove the inside door handle and the speaker bracket (remove the door panel bracket for coupe), then peel off the plastic shield without tearing it.

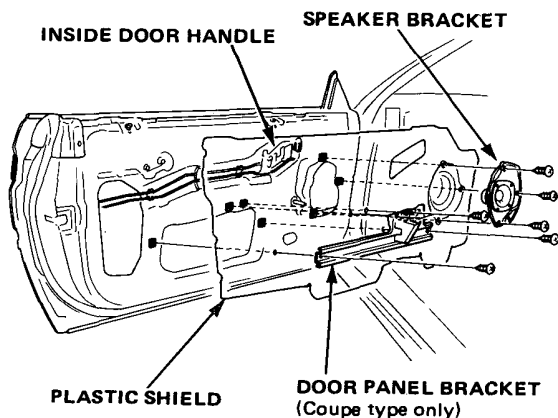

7. Remove the outside door handle mounting nuts for the coupe, or the outside door handle mounting bolts for other models.

Coupe:

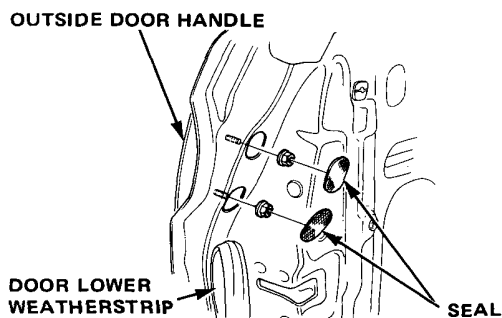

2D H/B, 4D, and 4D H/B:

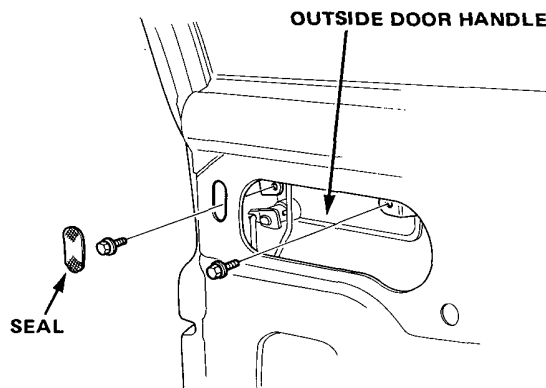

8. On the front doors, pull out the retainer, and take out the lock cylinder, then disconnect the lock cylinder and rod.

Coupe:

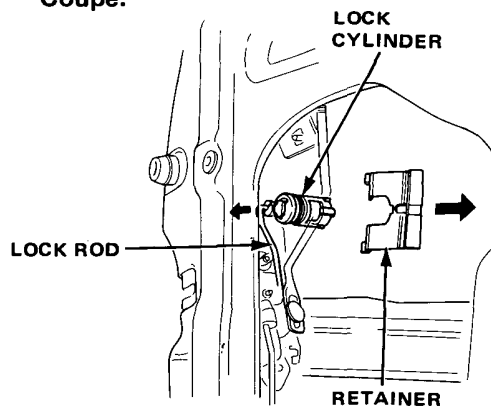



2D H/B, 4D, and 4D H/B:

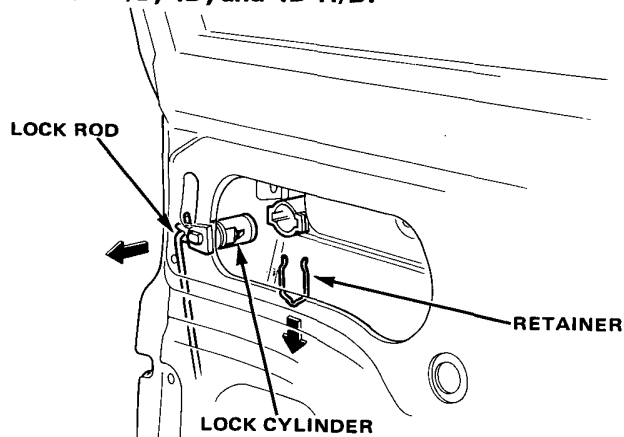

9. On the rear doors, remove the screws and then the lock crank, then disconnect the lock crank and rods.

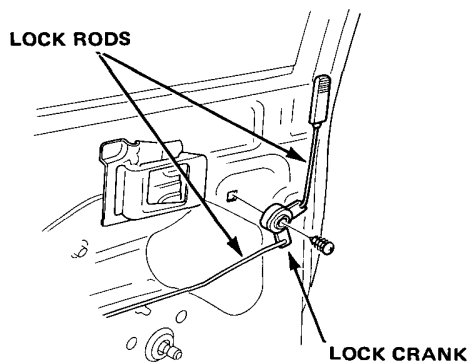

10. Remove the screws and take the door latch off the door, then push the door latch and rod inside the door.

NOTE: When moving the door latch, take care not to bend the rod excessively.

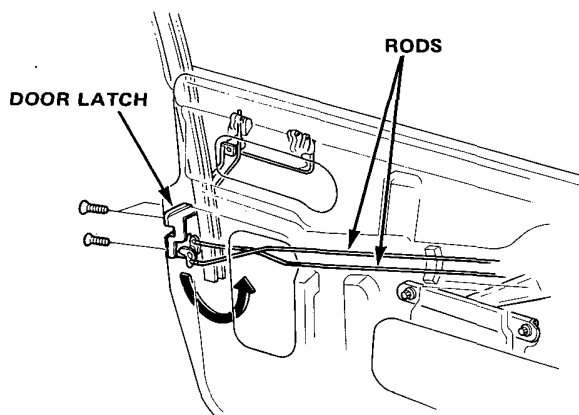

11. Pull the outside handle out, then unscrew it off the latch rod.

NOTE:

- Take care not to scratch the door with the door handle.
- Note the location of the handle on the rod before removing.

Coupe:

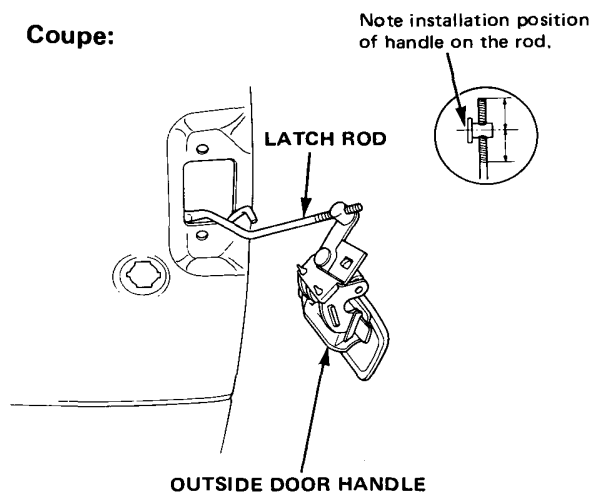

2DH/B, 4D, and 4D H/B:

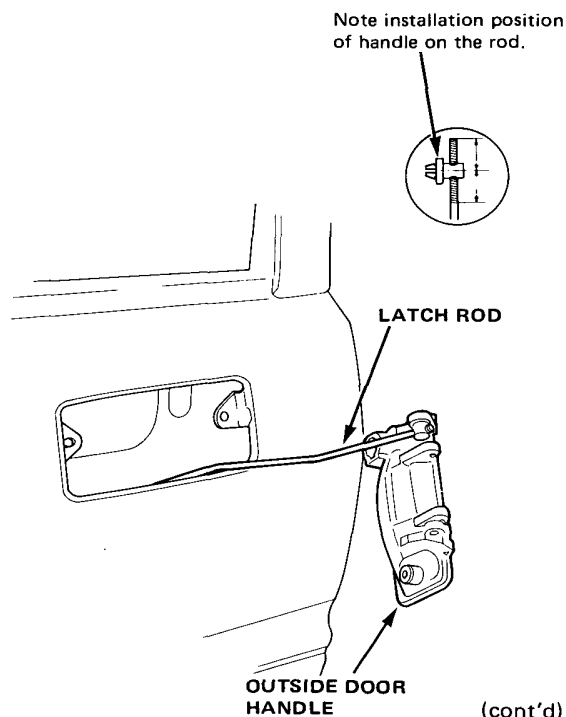

(cont'd)

Door

Disassembly (cont'd)

12. To remove the outer molding, pull away the end of the door lower weatherstrip slightly, then remove the outer molding mounting screws for coupe, or lift it straight up off the window sill for other models.

Coupe:

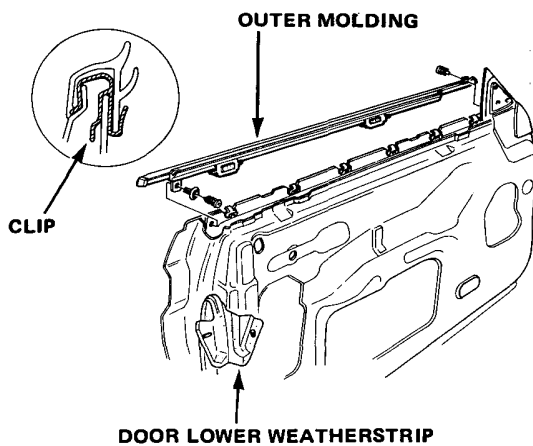

2D H/B, 4D, and 4D H/B:

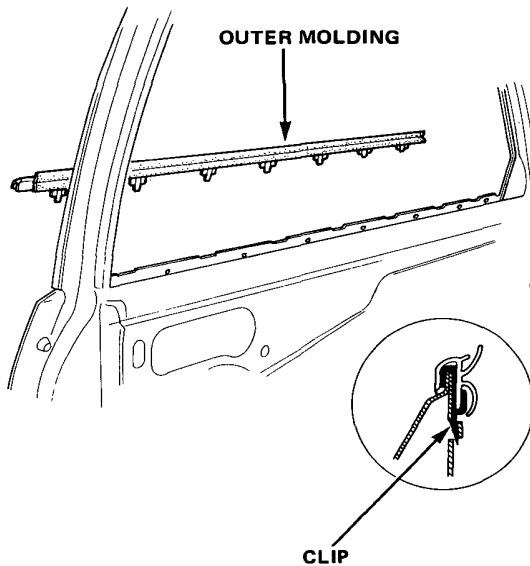

13. On coupe only, remove the bolts and stabilizers.

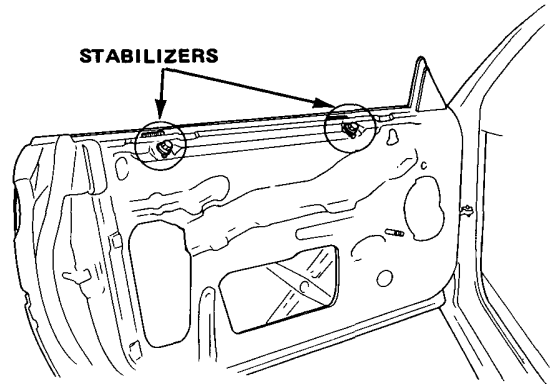

14. On the rear doors, remove the screws and bolts securing the center channel, then remove the quarter glass from the door sash.

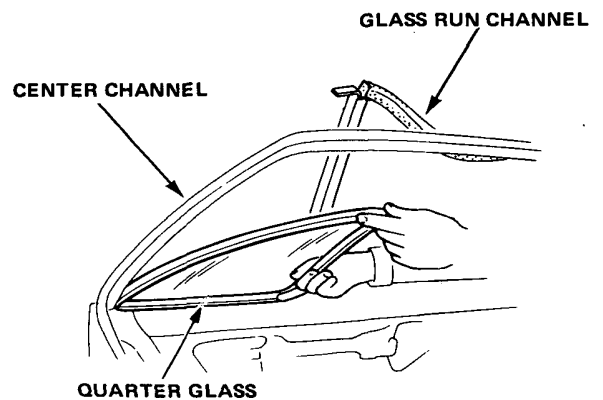
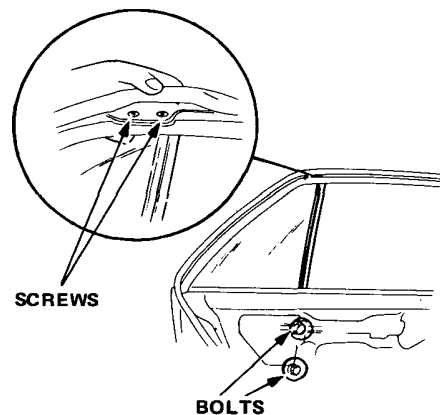



15. Carefully lower the door glass until you can see its mounting nuts (for coupe) or its mounting bolts (for other models).

Coupe, 2DH/B, and 4D Front Doors:

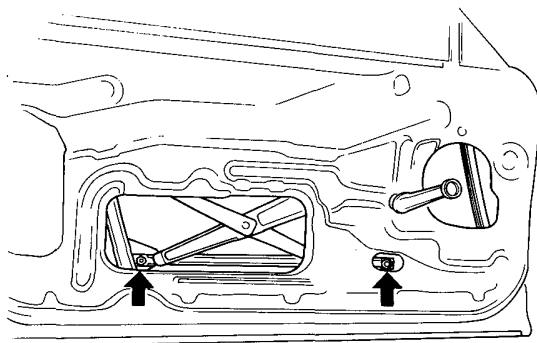

4DH/B Front Door / 4D and 4D H/B Rear Doors:

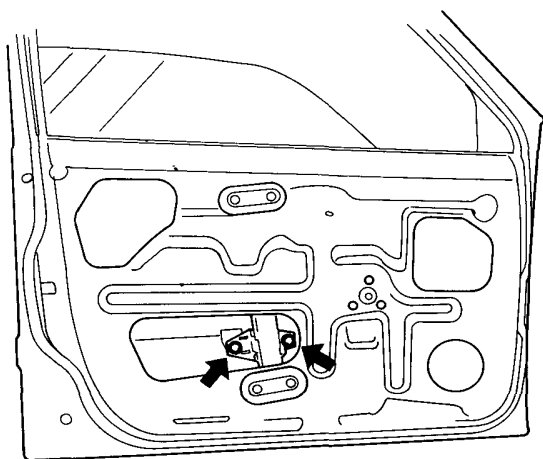

16. Stand next to the inside of the door, tilt the door glass as shown, and pull it out through the window slot.

CAUTION: To avoid damaging the door glass, store it in a safe place.

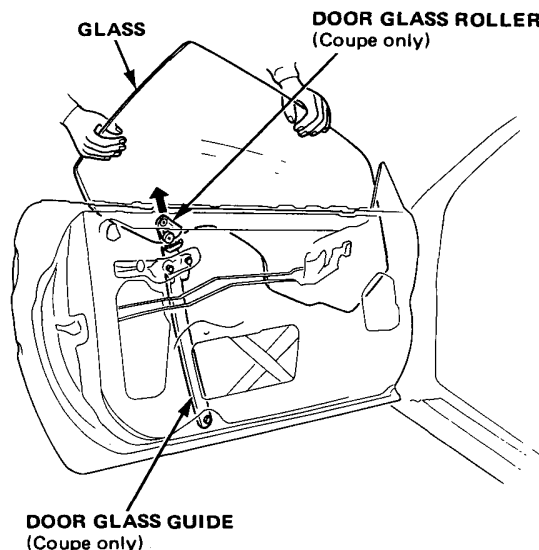

17. Remove the regulator mounting bolts, then take out the regulator assembly through the lower hole in the door.

Coupe, 2DH/B, and 4D H/B Front Doors:

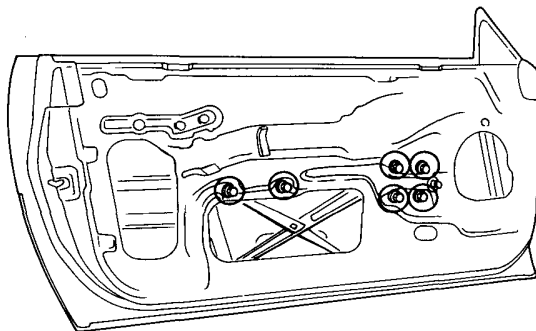

NOTE: Inspect for regulator gear wear, damage, spring slackness, loose linkage, etc. Replace parts as necessary.

(cont'd)

Door

Disassembly (cont'd)

4D H/B Front Door / 4D and 4DH/B Rear Doors:

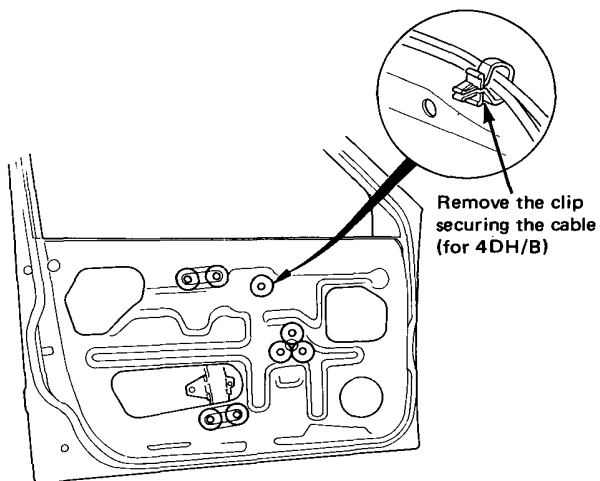

NOTE: Inspect the regulator cables for wear, damage, or worn guides. Also check that the carrier plate isn't loose. Replace parts as necessary.

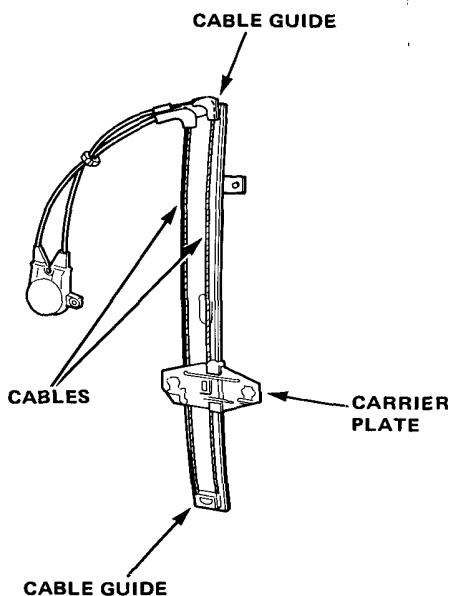

18. Remove the front sash, channel, and door glass guide:

Coupe:

Remove the 3 bolts and adjuster lock nut, then the 3 glass guide nuts.

NOTE:

- Scribe a line across the lock nut and door to ensure original adjustment.
- Hold the adjuster with a screwdriver when removing the lock nut.

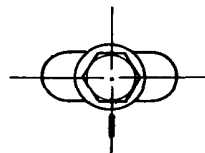

Front channel hook engages front sash here.

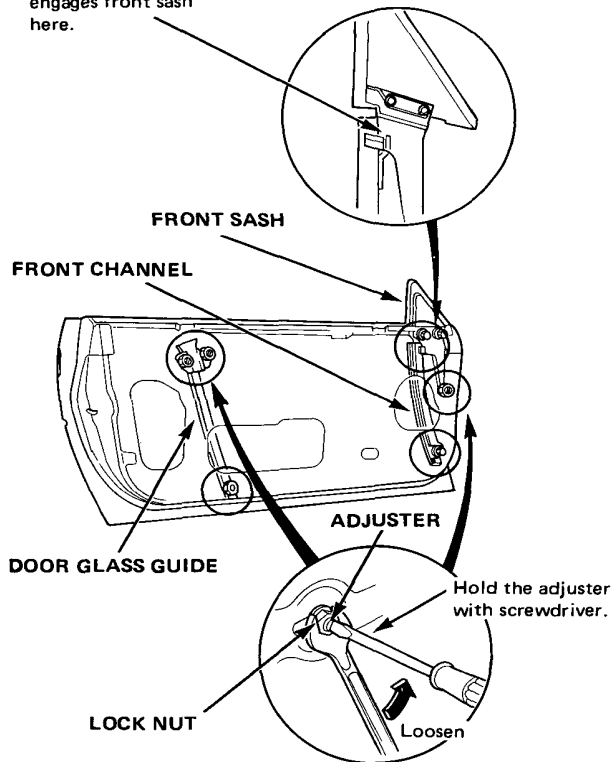



2DH/B, 4D, and 4D H/B:

Remove the 2 bolts and the 2 screws.

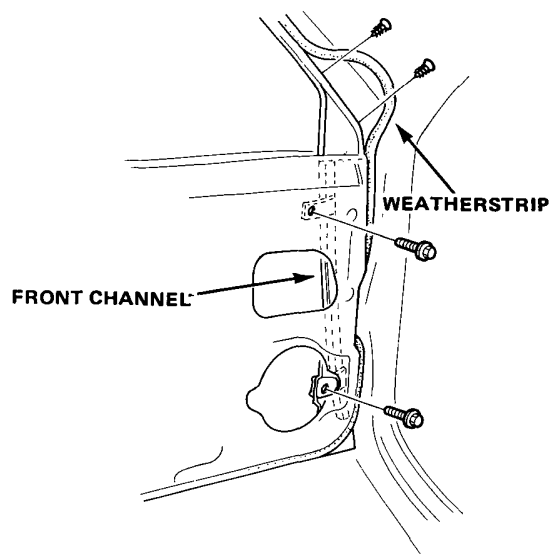

19. For 2D H/B only, remove the screws and then the door sash garnish.

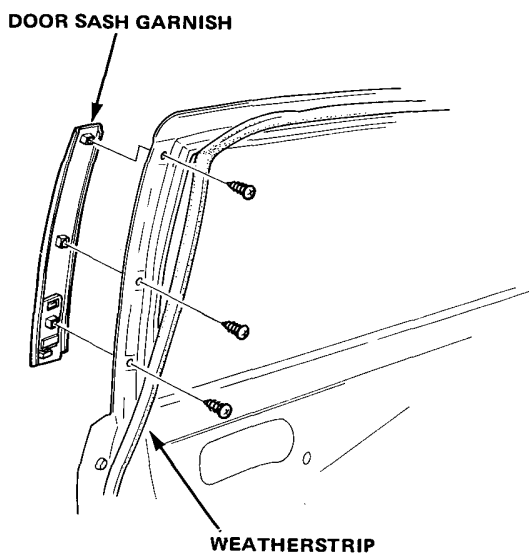

20. Remove the moldings as shown.

Door Sash and Center Molding Removal:

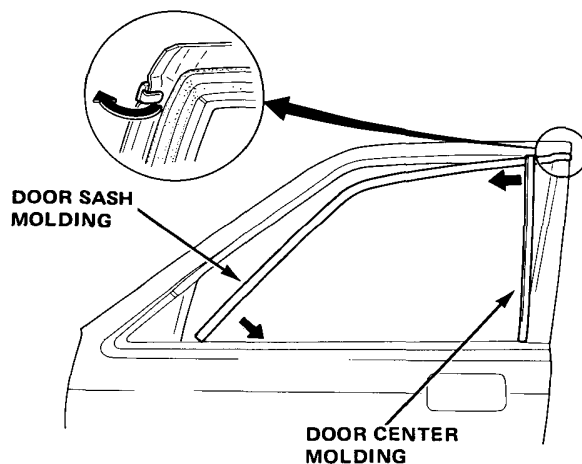

Door Corner Molding Removal:

Front Doors

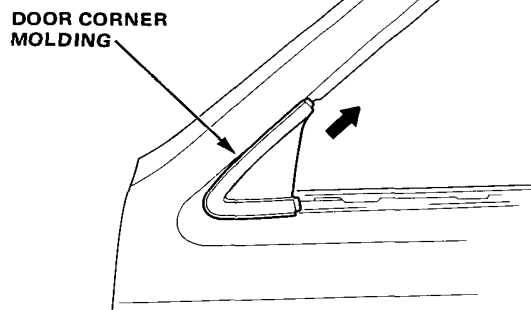

Rear Doors

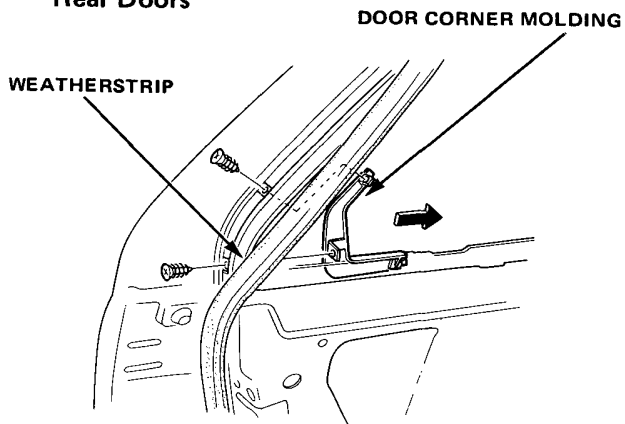

(cont'd)

Door

Disassembly (cont'd)

21. Remove the door side molding and garnish (for coupe only).

Coupe:

Peel off the door side molding, then remove the screws.

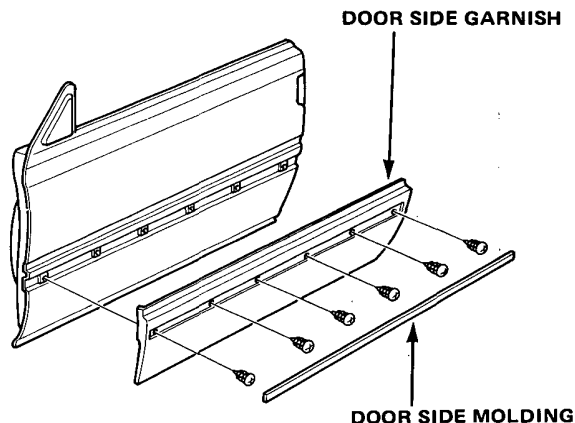

2DH/B, 4D, and 4D H/B:

Remove the plastic nuts from inside.

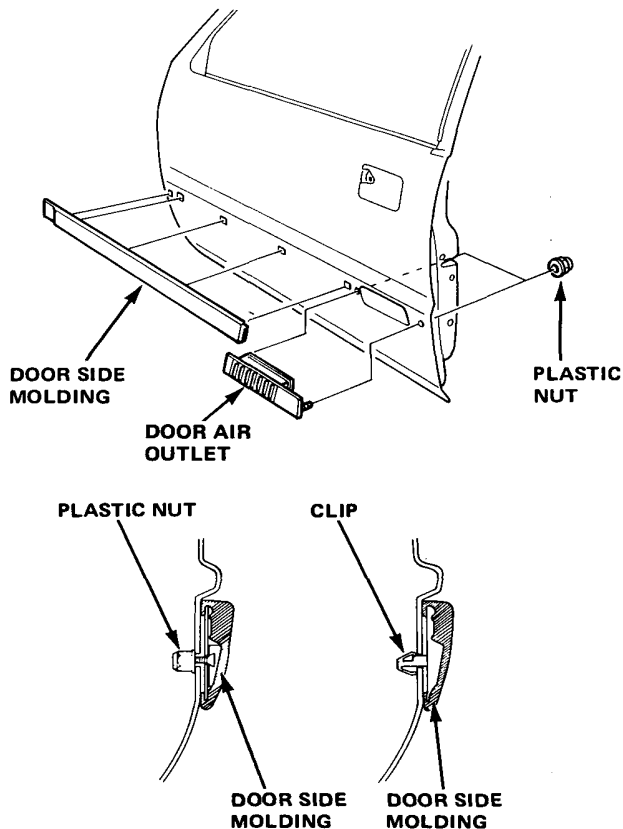

Removal

1. Cover the platform of a floor jack with several rags, then support the weight of the door with the jack.

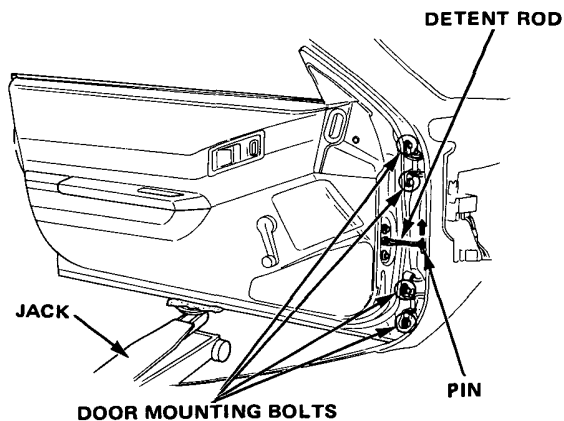

2. Use a hammer to drive the pin out of the detent rod.
3. With a helper balancing the door on the jack, remove the upper and lower door mounting bolts.
4. If necessary, remove the hinge mounting bolts, and remove the hinges.

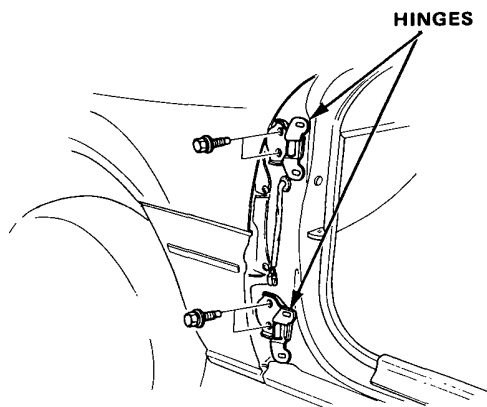



Assembly

Assemble the door in the reverse order of disassembly, and also:

1. Grease all the sliding surfaces of the window regulator where shown.

Coupe, 2DH/B, and 4D Front Doors:

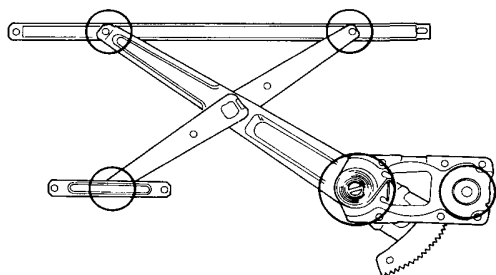

4DH/B Front Door / 4D and 4D H/B Rear Doors:

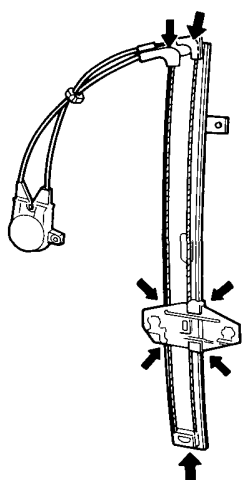

2. Roll the glass up and down to see if it moves freely without binding. Also make sure that there is no clearance between the glass and door upper weatherstrip (for coupes) or between the glass and door sash (for other models) when the glass is closed. Adjust the position of the door glass as necessary (see pages 22-20 to 25).

Coupe:

DOOR UPPER WEATHERSTRIP

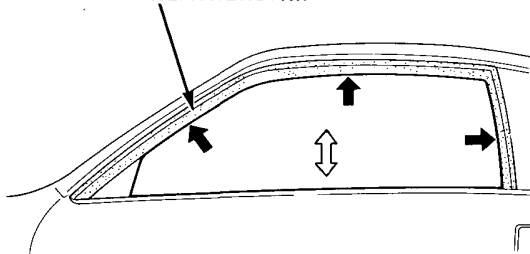

2D H/B, 4D, and 4D H/B:

DOOR SASH

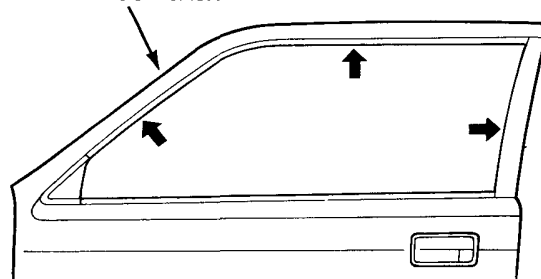

(cont'd)

Door

Assembly (cont'd)

3. When reinstalling the plastic shield, apply adhesive along the edge where necessary to maintain a continuous seal and prevent air/water leaks.

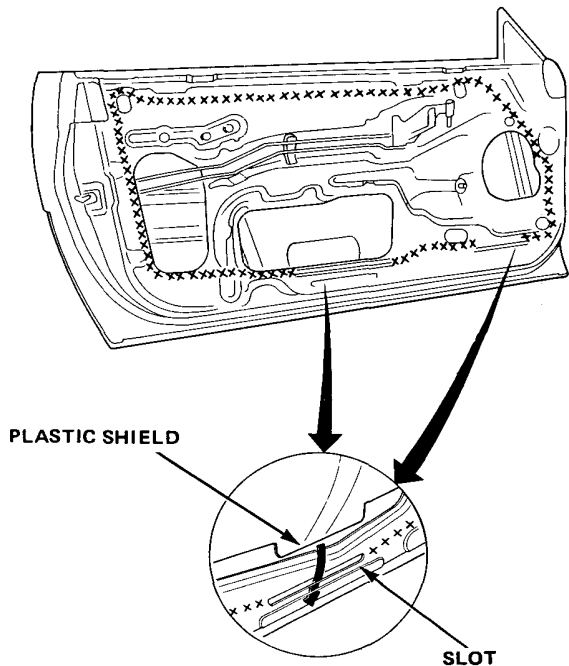

NOTE: Insert the shield into the slots where adhesive is not applied.

4. Install the regulator handle so it points forward, and up at a 45 degree angle with the window closed.

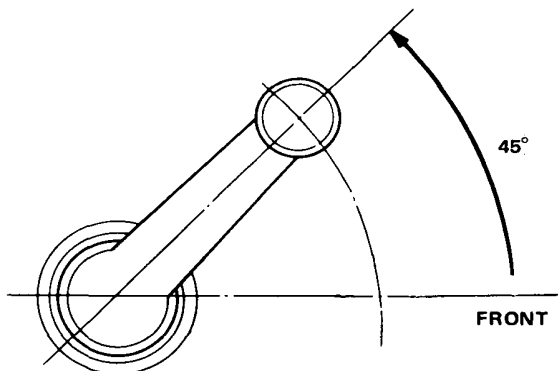

Door Position Adjustment

After installing the door, check for a flush fit with the body, then check for equal gap between the front and rear, and top and bottom door edges and the body. The door and body edges should also be parallel. Adjust at the hinges as shown.

CAUTION: Place a rag or shop towel on the jack to prevent damage to the door when the hinge bolts are loosened for adjustment.

HINGE MOUNTING BOLTS

Loosen the bolts, and move the door BACKWARD or FORWARD, UP or DOWN as necessary to equalize the gaps.

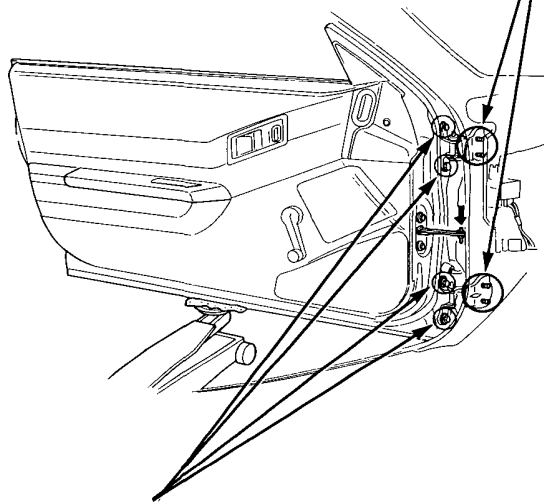

DOOR MOUNTING BOLTS

Loosen the bolts slightly to move the door IN or OUT until flush with the body. If necessary, you can install a shim behind one hinge to make the door edges PARALLEL with the body.



Door Striker Adjustment

Make sure the door is not loose, and latches securely without slamming. If it needs adjustment:

1. Draw a line around the striker plate for reference.
2. Loosen the striker screws, and move the striker IN or OUT to make the latch fit tighter or looser. Move the striker UP or DOWN to align it with the latch opening. Then lightly tighten the screws and recheck.

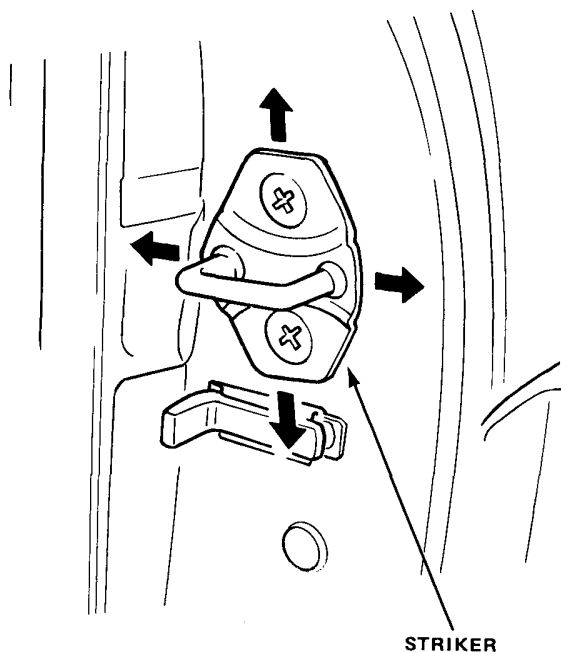

NOTE: Hold the outside handle out and push the door against the body to be sure the striker allows a flush fit.

3. If the door latches properly, tighten the screws and recheck.

Mirror Glass Replacement

1. Insert a screwdriver in the mirror through the service hole, and loosen the glass retaining screws.

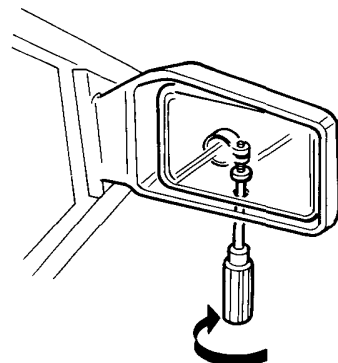

2. Carefully pry out the mirror with a screwdriver as shown.

CAUTION: To prevent damage to the mirror, wrap the end of the screwdriver with a rag or shop towel.

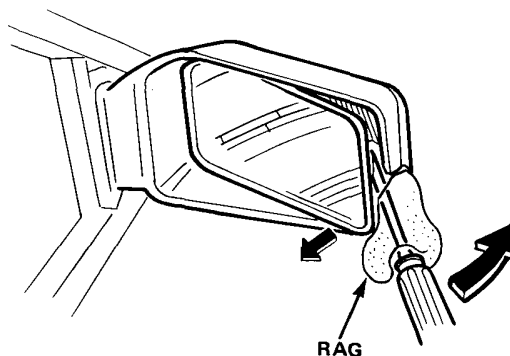

3. Install the mirror in the reverse order of removal, and also apply grease to the location indicated by the arrow.

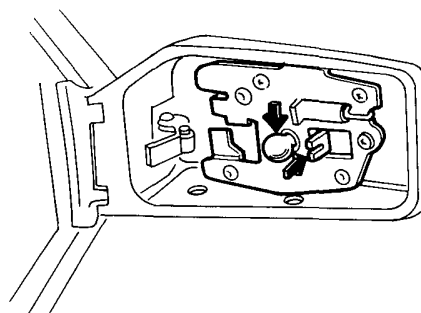

Door

Glass Adjustment (Coupe)

- ① : Inclination Adjustment
- ② : Forward / backward Adjustment
- ③ : Vertical Adjustment
- ④ : Window-to-Weatherstrip Seal Adjustment
- ⑤ : Front Sash Angle Adjustment

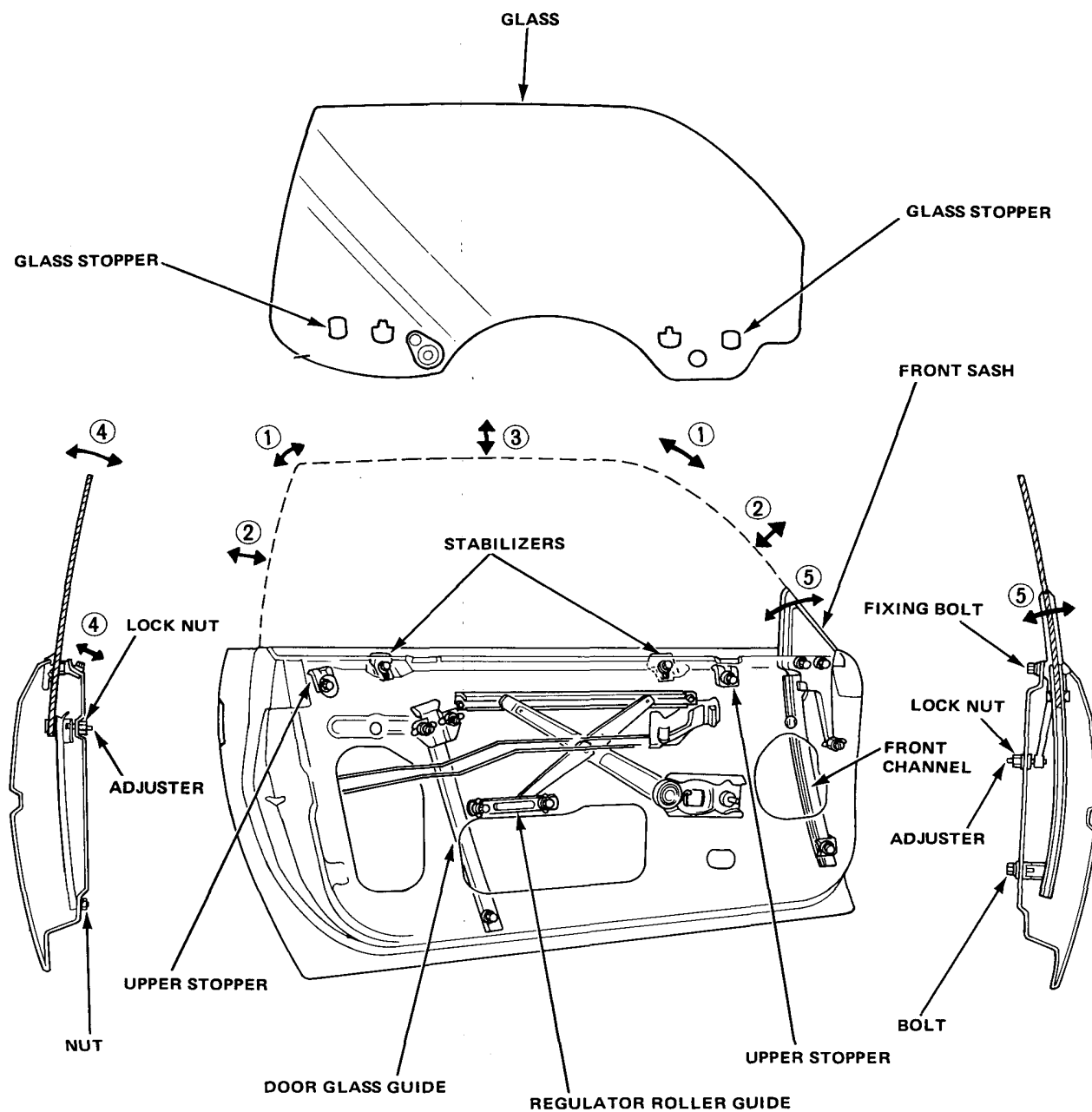



Inclination Adjustment

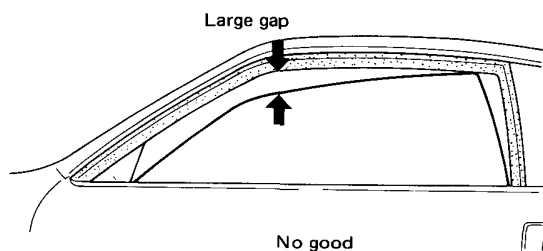
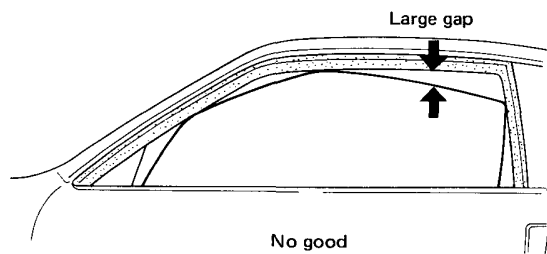

1. In this case move the roller guide up and down to arrange parallelism of the glass edge with the weatherstrip retainers on the front and center pillars as shown below.

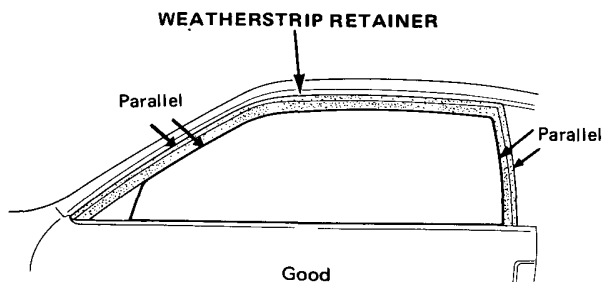

NOTE: Be sure to position the bolts of the roller guide to be parallel in the adjuster slots as shown.

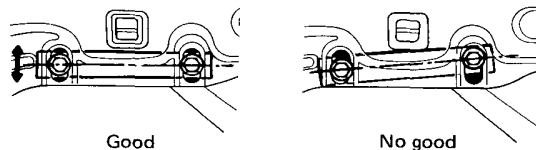

2. With the glass rolled up, if two upper stoppers do not equally contact the glass stoppers, loosen the upper stopper mounting bolts and eliminate gap to get equal contact. Then retighten the bolts.

UPPER STOPPER

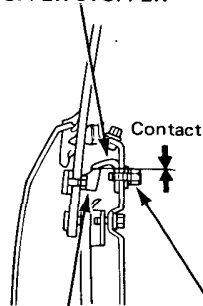

GLASS STOPPER

Good

UPPER STOPPER MOUNTING BOLT

Good

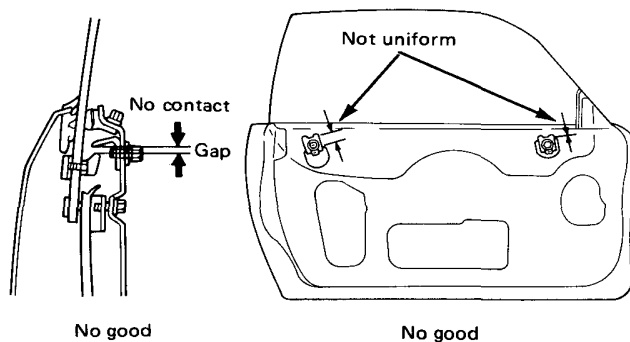
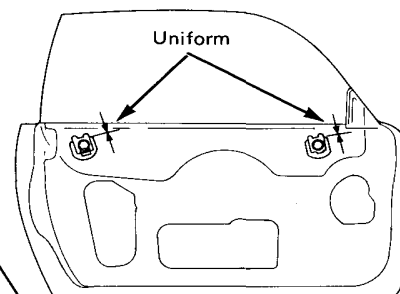

(cont'd)

Door

Glass Adjustment (Coupe cont'd)

Forward/Backward Adjustment

1. Hold the adjust bolt of the door glass guide with a screwdriver, then loosen the upper and lower nuts of the door glass guide, and shift the glass to the front or rear.

NOTE: The clearance between the rear edge of the glass and weatherstrip retainer on the center pillar should be 10 ± 1.5 mm (0.39 ± 0.06 in.) with the glass closed fully.

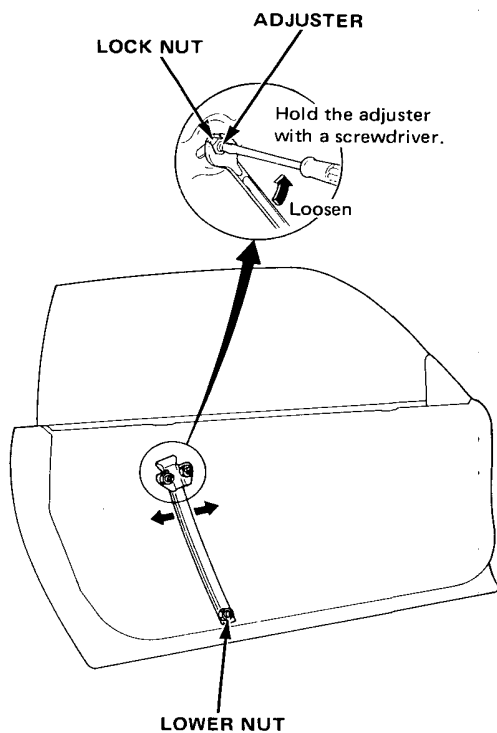
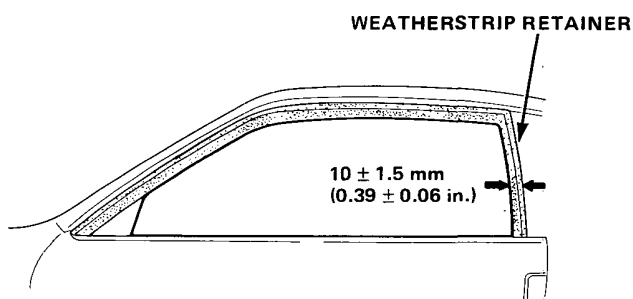

Vertical Adjustment

1. Push down lightly on the top edge of the glass, just enough to take up regulator free play.

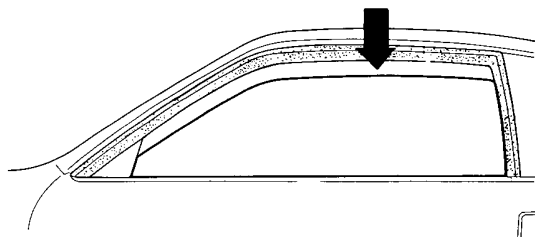

2. Adjust the height by evenly moving both upper stoppers (see page 22-21) to maintain uniform contact.

NOTE: The clearance between the top edge of the glass and the weatherstrip retainer in the upper door sill should be 16.2 ± 1.5 mm (0.64 ± 0.06 in.) with the glass fully closed.

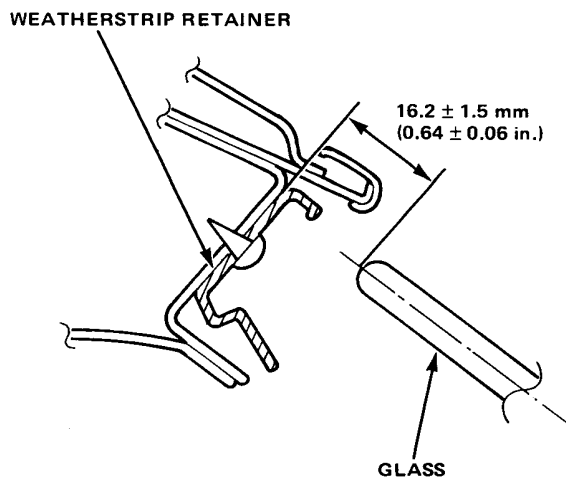



Window-to-Weatherstrip Seal Adjustment

1. Loosen the upper lock nut of the door glass guide, and adjust by turning the adjusters to obtain the correct clearance against the inner flange of the upper weatherstrip retainer.

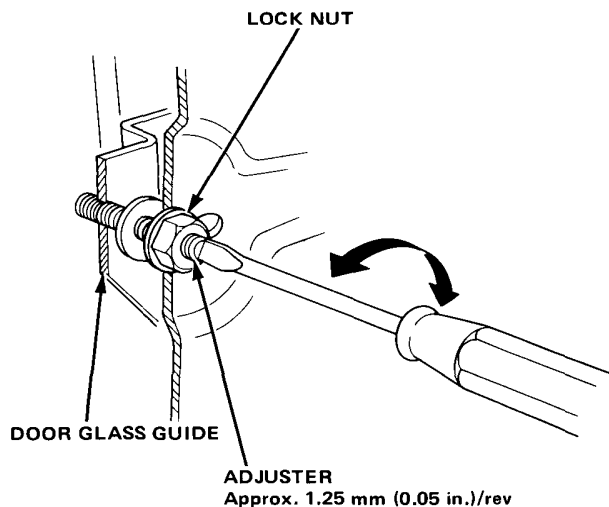
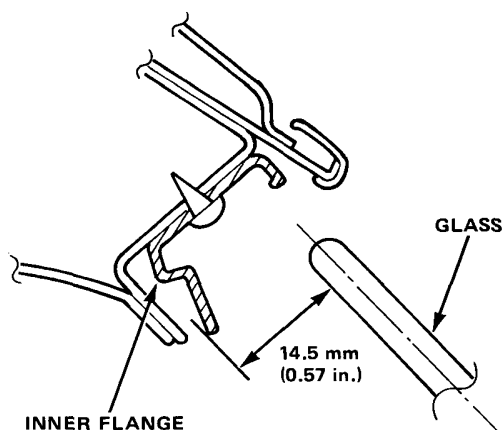

	Turn Adjuster:	To move Top Edge of Glass:
Direction	Right	In
	Left	Out
Adjustable Length	$\pm 4 \text{ mm}$ ($\pm 0.16 \text{ in.}$)	$\pm 15.42 \text{ mm}$ ($\pm 0.61 \text{ in.}$)

NOTE:

- Since it is possible to accidentally shift the front-to-back position of the glass when making the window angle adjustment, make the position of the door glass guide bolts before loosening them.

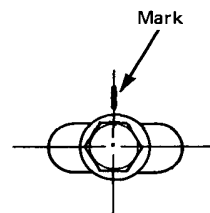

- Turn the 2 adjusters equally to prevent the door glass guide front slanting.

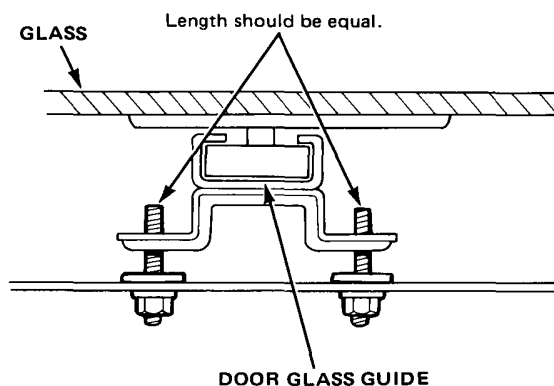

2. Push the front and rear stabilizers against the glass, then tighten the fixing bolts to eliminate play in the glass.

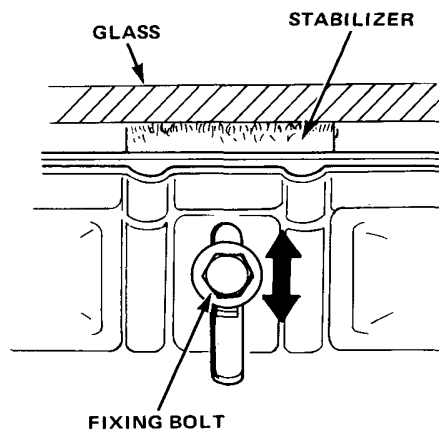

(cont'd)

Door

Glass Adjustment (Coupe cont'd)

Front Sash Angle Adjustment

1. Loosen the lock nut of the front sash, and turn the adjuster so the front sash channel follows the contour of the glass.

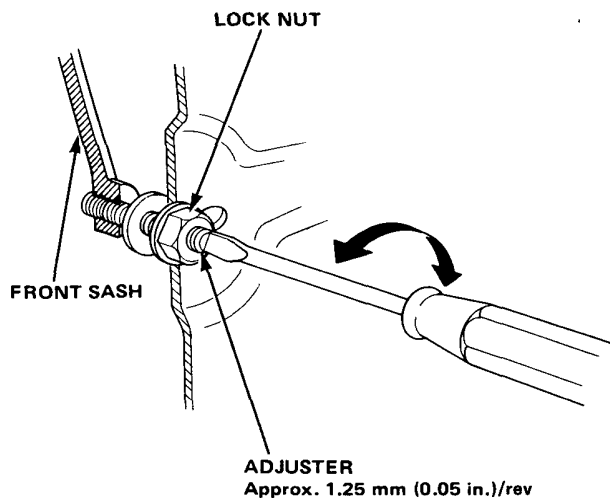
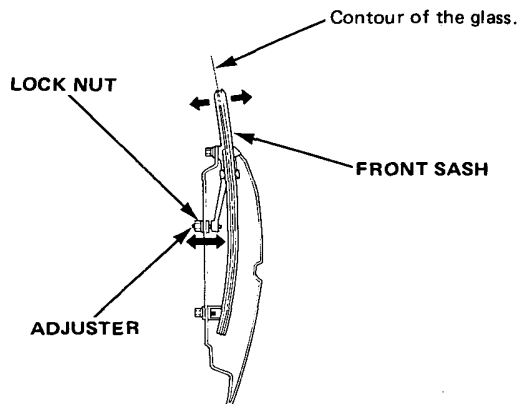

	Turn Adjuster:	To move Top Edge of Glass:
Direction	Right	Out
	Left	In
Adjustable Length	± 5 mm (± 0.20 in.)	± 4.68 mm (± 0.18 in.)

2. Hold the adjuster of the front sash with a screwdriver, then loosen the 2 upper bolts and the lock nut of the front sash, and make adjustment by shifting the front sash to the front or rear.

NOTE: Check that the front sash and glass are in line with each other as shown.

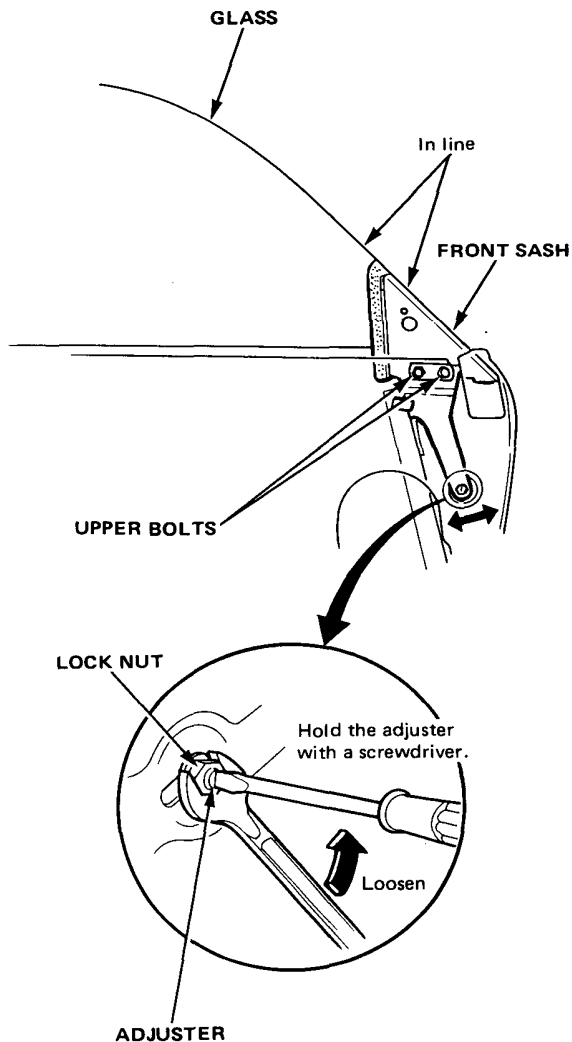



Glass Adjustment (2D H/B, 4D, and 4D H/B)

If the glass does not fit evenly in the window opening channel when closed:

1. Loosen the regulator roller guide bolts (for arm type regulator), or the guide rail bolts (for cable type regulator).
2. Roll the glass all the way up, sliding it forward or backward until it fits properly.
3. Retighten the bolts.

2DH/B and 4D Front Doors:

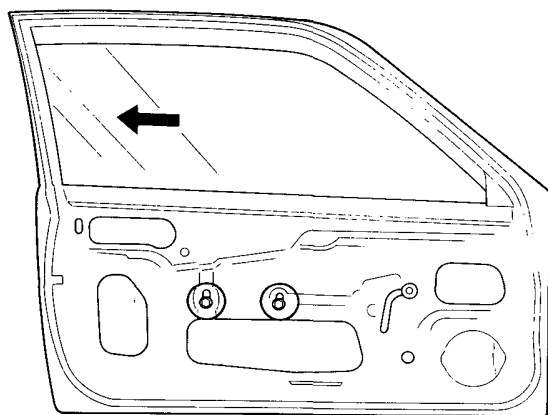

4D H/B Front Door:

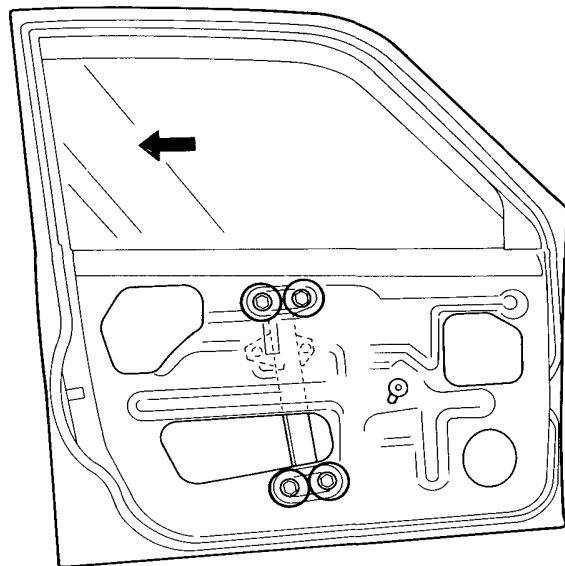

4D and 4D H/B Rear Doors:

